

PARCEL OF LAND.....PT DE WITT LOCATION 166 BEING  
LOT 345 DIAGRAM 66077

CERTIFICATE OF TITLE :.....VOLUME 1704 FOLIO 485

LOCAL AUTHORITY.....SHIRE OF ROEBOURNE

LOCALITY.....DAMPIER.....INDEX PLAN.....

NAME OF BUILDING.....EAGLEHAWK COURT

ADDRESS FOR SERVING OF.....P.O. BOX 21  
NOTICES ON COMPANY.....DAMPIER W.A. 6713



LODGED.....24. 9. 85.....75915

EXAMINED.....2. 10. 85 RM

REGISTERED.....24-12-85 App. D173429



*S. J. Longthorn*  
REGISTRAR OF TITLES

LIMITED TO A DEPTH OF 12.19 METRES.

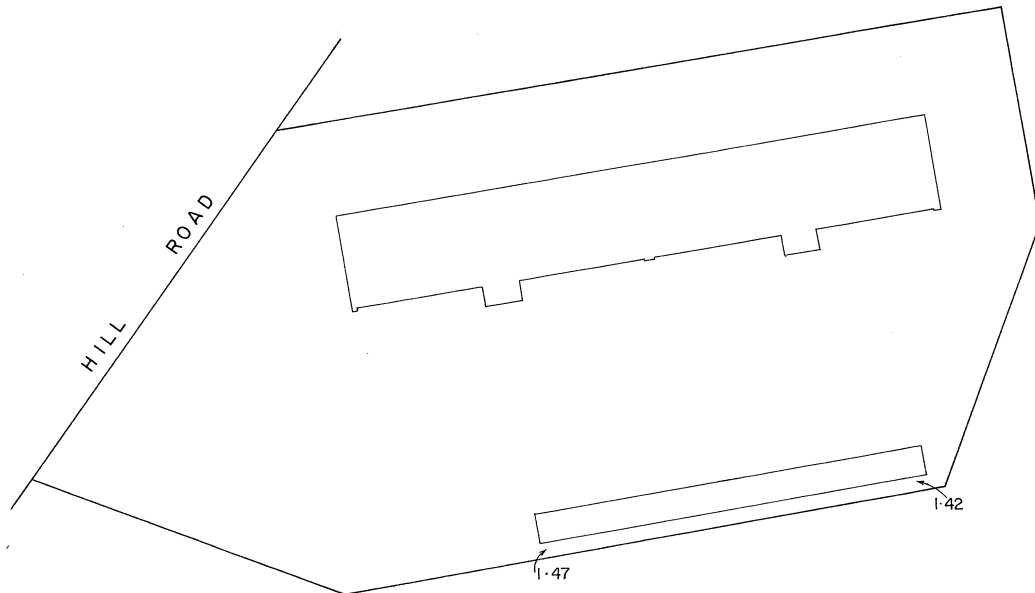

PT LOC 38

SCALE.....1: 500



SCHEDULE OF UNIT ENTITLEMENT		OFFICE USE ONLY		SURVEYOR'S CERTIFICATE
LOT No.	UNIT ENTITLEMENT	CURRENT Cs. of TITLE		
		VOL.	FOL.	
				<p>I hereby certify that the building shown on the plan is within the external surface boundaries of the parcel and where eaves or guttering project beyond those boundaries, that a registered easement has been granted as an appurtenance of the parcel or, where the projection is over a road that the Local Authority has consented thereto.</p> <p><i>A. Porteous</i></p> <p>DATE 15-3-85 LICENSED SURVEYOR.</p> <p>APPROVED BY THE TOWN PLANNING BOARD FOR THE PURPOSES OF THE STRATA TITLES ACT 39 OF 1966</p> <p><i>W. A. Fisk</i></p> <p>- 7 MAY 1985</p> <p>DATE..... CHAIRMAN.</p>
AGGREGATE				

77241/6/78-2M-MS/893

FORM 3

STRATA PLAN No. 13203

**CERTIFICATE OF LOCAL AUTHORITY**

FOR THE PURPOSES OF THE STRATA TITLES ACT 39 OF 1966

SHIRE OF ROEBOURNE

, THE LOCAL AUTHORITY,

**HEREBY CERTIFIES THAT:—**

- (1) The building shown on the plan has been inspected and that it is consistent with the building plans and specifications in respect thereof that have been approved by the Local Authority.
- (2) The building, in the opinion of the local authority, is of sufficient standard and suitable to be divided into lots pursuant to the Strata Titles Act, 1966.

**DESCRIPTION OF BUILDING:—** A TRIPLE STOREY CONCRETE MASONRY BUILDING

CONTAINING 12 RESIDENTIAL UNITS TOGETHER WITH A SINGLE STOREY BRICK BUILDING CONTAINING 12 STORAGE UNITS BOTH ROOFED WITH ALUMINIUM SHEET AND SITUATED ON LOT 345 PT DE WITT LOCATION 166 ON DIAGRAM 66077 AND CONTAINED IN CERTIFICATE OF TITLE VOL.1704 FOL. 485 AND KNOWN AS EAGLEHAWK COURT.

DATE .....

22 APR 1985

  
SHIRE/TOWN CLERK

<div style="border-bottom: 1px solid black; margin-bottom: 5px;"> <div style="display: flex; justify-content: space-between; padding: 0 10px;"> <span>APPROVED</span> <span>FOR THE PURPOSES OF THE STRATA TITLES ACT 39 OF 1966 AS AMENDED</span> </div> </div>	
<div style="display: flex; justify-content: space-between;"> <div style="width: 45%;"> <p>TOWN PLANNING BOARD</p> <p><i>[Signature]</i></p> <p>- 7 MAY 1985</p> <p>Date.....</p> </div> <div style="width: 45%; text-align: center;"> <p>CHAIRMAN.</p> </div> </div>	<div style="display: flex; justify-content: space-between;"> <div style="width: 45%;"> <p>LOCAL AUTHORITY.....SHIRE OF ROEBOURNE</p> <p><i>[Signature]</i></p> <p>Date 22 APR 1985.....</p> </div> <div style="width: 45%; text-align: center;"> <p>SHIRE/TOWN CLERK.</p> </div> </div>

GROUND FLOOR

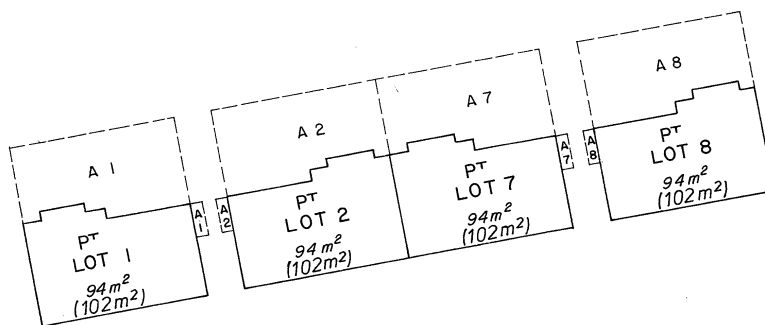

C/P1	C/P2	C/P3	C/P4	C/P5	C/P6	C/P7	C/P8	C/P9	C/P10	C/P11	C/P12
Pt 1	Pt 2	Pt 3	Pt 4	Pt 5	Pt 6	Pt 7	Pt 8	Pt 9	Pt 10	Pt 11	Pt 12
8m²	8m²	8m²	8m²	8m²	8m²	8m²	8m²	8m²	8m²	8m²	8m²



"FOR THE USE OF"  
ENDORSEMENT HAS NO EFFECT  
UNLESS OTHER ACTION PERMITTED  
UNDER THE ACT HAS BEEN TAKEN.

*[Signature]*  
Registrar of Titles

Note: Areas 'A' and carports 'C/P' for use exclusively with lots as numbered.  
For other parts of lots, see Sheets 2 & 3 of 3 sheets.

SCALE 1: 400

APPROVED

FOR THE PURPOSES OF THE STRATA TITLES ACT 39 OF 1966 AS AMENDED

TOWN PLANNING BOARD

*[Signature]*

- 7 MAY 1985

DATE

CHAIRMAN

LOCAL AUTHORITY SHIRE OF ROEBOURNE

*[Signature]*

DATE

22 APR 1985

SHIRE TOWN CLERK

FIRST FLOOR

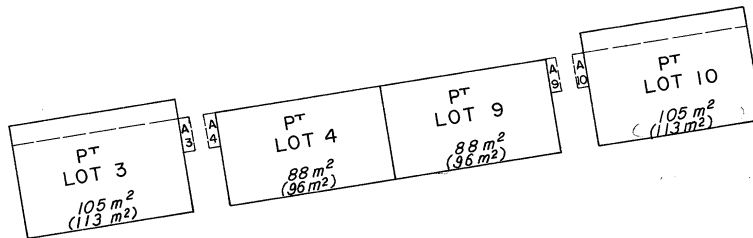

"FOR THE USE OF"  
ENDORSEMENT HAS NO EFFECT  
UNLESS OTHER ACTION PERMITTED  
UNDER THE ACT HAS BEEN TAKEN.

*[Signature]*  
Registrar of Titles

Note : Areas 'A' for use exclusively with lots as numbered.  
For other parts of lots, see Sheet 1 of 3 sheets.

SCALE 1:400

APPROVED

FOR THE PURPOSES OF THE STRATA TITLES ACT 39 OF 1966 AS AMENDED

TOWN PLANNING BOARD

*[Signature]*

7 MAY 1985

DATE CHAIRMAN

LOCAL AUTHORITY SHIRE OF ROEBOURNE

DATE 22 APR 1985

SHIRE TOWN CLERK

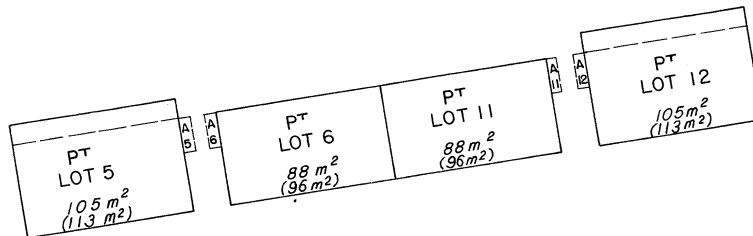

"FOR THE USE OF"  
ENDORSEMENT HAS NO EFFECT  
UNLESS OTHER ACTION PERMITTED  
UNDER THE ACT HAS BEEN TAKEN.  
*[Signature]*  
Registrar of Titles

Note: Areas 'A' for use exclusively with lots as numbered.  
For other parts of lots, see Sheet 1 of 3 sheets.

SCALE 1:400

APPROVED

FOR THE PURPOSES OF THE STRATA TITLES ACT 39 OF 1966 AS AMENDED

TOWN PLANNING BOARD

*[Signature]*

27 MAY 1985

DATE.....CHAIRMAN

LOCAL AUTHORITY SHIRE OF ROEBOURNE

*[Signature]*

DATE 22 APR 1985 SHIRE/TOWN CLERK

[illegible][illegible]

**NOTE : ENTRIES RULED THROUGH AND AUTHENTICATED BY THE SIGNATURE OF THE REGISTRAR OF TITLES ARE CANCELLED.**

63673/10/69-500-G472