

PLAN 17813

SUBDIVISION OF  
**PT DE WITT LOC 166**  
 F.B.s 48611, 48993, 48994, 48610, 60074, 60485, 48608  
 C/T. 1626/307

LIMITED IN DEPTH TO 12.19 METRES

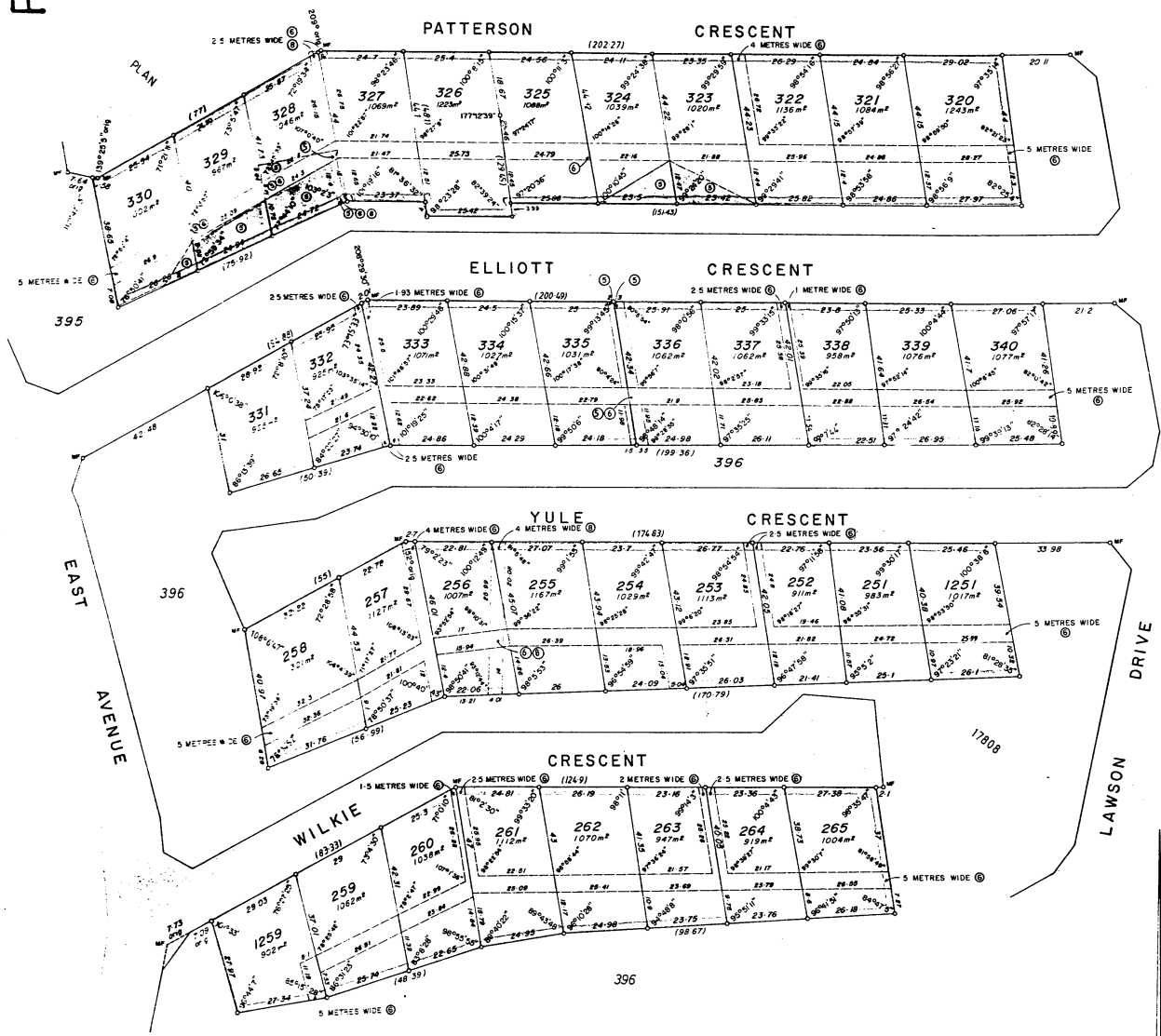

P 017813 F 01



TOTAL AREA - 3.9860 ha

DRAINAGE EASEMENT TO THE SHIRE OF ROEBURNE UNDER REG 5 OF T.P.B.D. ACT, SEC 27A.  
 SEWERAGE EASEMENT & WATER EASEMENT TO MIN OF WATER RESOURCES UNDER REG 6 OF T.P.B.D. ACT, SEC 27A.  
 UNDERGROUND ELECTRIC EASEMENT TO S.E.C UNDER REG 8 OF T.P.B.D. ACT, SEC 27A.

RE-APPROVED AS AMENDED (REMOVAL OF DRAINAGE EASEMENT BETWEEN LOTS 324 & 325 PATTERSON CRESCENT.)  
*A. J. L. ...*  
 INSPECTOR OF PLANS & SURVEYS  
 DATE 12/10/91

Subject to approval of plan 17805 = 27/10/91  
*R. ...*

**CERTIFICATE**  
 I hereby certify that this survey was performed by me personally (or under my own personal supervision, inspection and field check) in strict accordance with the Licensed Surveyors (Guidance of Surveyors) Regulations, 1961.  
 Date 3/12/95  
*[Signature]*  
 Licensed Surveyor

Approved by Town Planning Board  
 1990  
 77180  
*[Signature]*  
 Chairman

SCALE  
 0 10 20 30 40 50 60 70 80 90  
 ALL DISTANCES ARE IN METRES  
 Approved, *[Signature]*  
 Inspector of Plans and Surveys.  
 Examined *[Signature]* Date 27/10/91  
 CRT DIA 75065

OFFICE OF TITLES  
 PLAN No.  
**17813**