

LAND DESCRIPTION

ON

CERTIFICATE OF TITLE

FIELD BOOK

TOTAL AREA

PT LOT 3 OF VICTORIA LOC 2126 & PT LOT 260 OF VICTORIA LOCS 2126 & 9993

PLAN 20087
DIAGRAM 64390
INDEX BE43(2)16:12
PUBLIC

VOLUME FOLIO
1652 876
2016 412
Now 2056 308

69788

2.24
3-4189 ha

PLAN 21017



LOCAL AUTHORITY: SHIRE OF GREENOUGH

LIMITED IN DEPTH TO 12.19 METRES

LOCALITY: MOUNT TARCOOLA

LOCAL GOVERNMENT ACT
ALL ROADS WITHIN THE GREEN
BORDER ARE NOW DEDICATED.

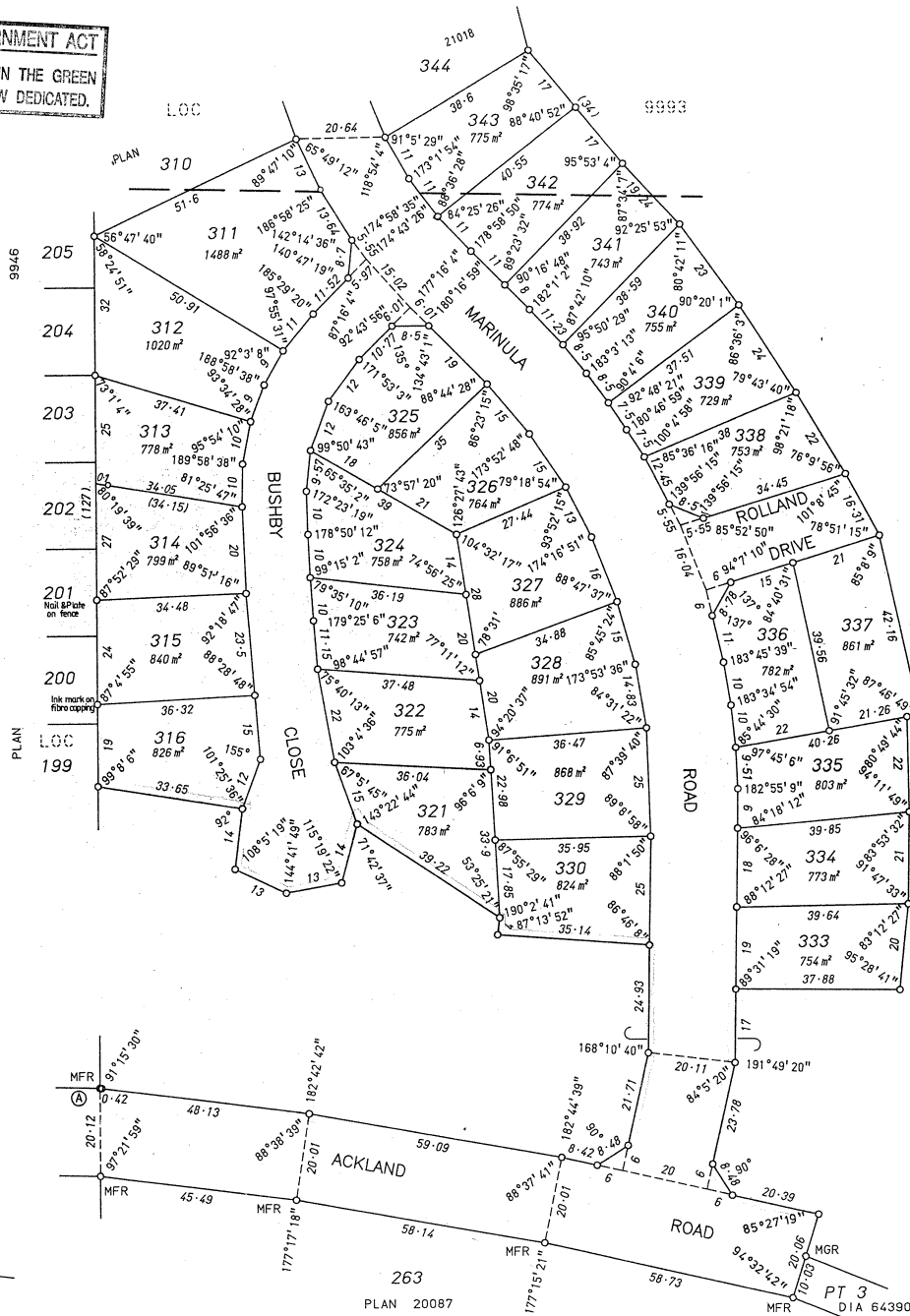

PT 260
PLAN 20087
2126

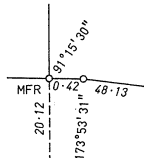

ENLARGEMENT AT A
NOT TO SCALE

MORRIS, HEYHOE & RICHARDS
Consulting Surveyors & Planners
8 ANZAC TERRACE GERALDTON

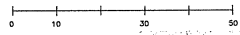

<p>SURVEYOR'S CERTIFICATE</p> <p>REG 54: I, <u>D. W. ROSENTHAL</u> hereby certify that:</p> <p>(a) this plan of survey is a correct and accurate representation of the survey carried out by me personally / under my own personal supervision, inspection and field check, and recorded in field books lodged for the purposes of this plan of survey;</p> <p>(b) the measurements are in strict accordance with the Licensed Surveyors' Guidance of Surveyors' Regulations 1961 and in particular Regulations 23 and 34 of those regulations; and</p> <p>(c) this survey and this plan of survey are in strict accordance with the requirements of the Licensed Surveyors' Guidance of Surveyors' Regulations 1961 and the relevant law in relation to which it is lodged.</p> <p>Licensed Surveyor: <u>D. W. Rosenthal</u> Date: <u>15-9-95</u></p>		<p>APPROVED BY STATE <u>WPS</u> PLANNING COMMISSION</p> <p>FILE: <u>94717</u></p> <p><u>Lesley James</u> FOR CHAIRMAN</p> <p>DATE: <u>11 Oct 95</u></p> <p>LODGED DATE: <u>25-9-95</u> FEE PAID: <u>\$1378</u></p> <p>ASSESSMENT</p>		<p>MINISTRY FOR PLANNING</p> <p>5 OCT 1995</p> <p>FILE 94717</p> <p>TYPE OF VALIDATION Full Audit Legal Cooperation CORRECT</p> <p>DOCKET PLAN/DIAGRAM: <u>89356</u> CERTIFIED CORRECT: <u>17/10/95</u> DATE</p>		<p>SCALE 1: 750 ALL DISTANCES ARE IN METRES</p> <p>IN ORDER FOR DEALINGS SUBJECT TO Sec 295(5) of L.G.A. * 2 owners</p> <p>APPROVED <u>17/10/95</u> DATE APPROVED INSPECTOR OF PLANS & SURVEYS</p>		<p>SUBDIVISION BY EARLY ISSUE PROCESS</p> <p>DOLA Department of LAND ADMINISTRATION</p> <p>OFFICE OF TITLES PLAN 21017</p>	
---	--	---	--	--	--	---	--	--	--